



REF: # 6402

FINESTRAT (FINESTRAT HILLS)



#### INFO

|                  |                                |
|------------------|--------------------------------|
| PRIX:            | 475.000 €                      |
| TYPE:            | Villa                          |
| CITY:            | Finestrat<br>(Finestrat Hills) |
| CHAMBRES:        | 3                              |
| Ba ENFANTS:      | 3                              |
| Built ( m2 ):    | 224                            |
| pas ( m2 ):      | 546                            |
| Terrasse ( m2 ): | 125+52                         |
| A ENFANTS:       |                                |
| de plante:       | 2                              |
| MESSAGE          | -                              |

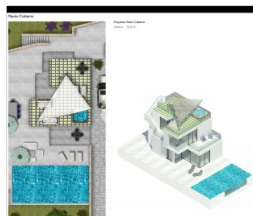

#### DESCRIPTION

The complex is developing a complex of 15 spacious villas with plots from 428 m2 to 776 m2 with the possibility of 4 bedrooms and 4 bathrooms. Safety Glass railing. Built-in wardrobes with paneling on the inside. Security entrance door. Motorized sliding door for the driveway. Home automation system with lighting control and video door opener. Bathroom tiled in porcelain or white paste stoneware tiles. Electrical installation according to Low Voltage Electro Technical Regulations. Mechanisms Niessen high end. Installation of plumbing in accordance with Regulation. Water points in barbecue and garden areas. TV and telephone installation. Installation of ducted air conditioning on the ground floor and first floor. Pre-installation for air conditioning in the basement. Pool with individual saltwater system on ground floor with safety glass front. Pool with individual saltwater system in the basement. (Only available on house type A) Blinds on windows. Basic lighting with

LED strips and LED spotlights. Floor heating in all bathrooms. Different trees in the garden. Located in one of the most charming regions on the Costa Blanca, balcony of Finestrat, surrounded by beautiful mountains with wonderful views of the Benidorm coast. Integrated into the hilly landscape of Finestrat, the houses are built with the aim to enjoy the natural environment that surrounds them and the surrounding facilities including three golf courses, two theme and recreation parks, and the beautiful beaches of Cala Finestrat and Benidorm. The villas are of the highest quality thanks to strict quality control performed by licensed companies with the distinction of ISO 9000. The employed materials are of world leading brands and benchmarks in interior design, such as Saloni, Inalco, Villeroy & Boch, Fantini, Dica, Bosch, etc. The approved building process is a reference both in quality of the materials and the finish. The security glass with cameras, and the type of insulation used in the construction of the villas, ensures a pleasant environment with a minimum of electricity consumption.



| STYLE   | VIEW  | CLIMATISATION   | DISTANCE :   |
|---|---|---|--|
| <ul style="list-style-type: none"><li>moderne</li></ul>                         | <ul style="list-style-type: none"><li>Panoramico</li><li>Ocean</li><li>une vue sur la montagne</li></ul>  | <ul style="list-style-type: none"><li>Central</li></ul>                         | Beach : 3 Km<br>aéroport: 50 Km<br>: 1 Km  |
| POSITION  | MEUBLÉ  | ZONES   | ÉTAGE  |
| Est sud   | <ul style="list-style-type: none"><li>Vide</li></ul>  | <ul style="list-style-type: none"><li>ou chambre Baignade</li></ul>             | <ul style="list-style-type: none"><li>tuiles</li></ul>   |
| CUISINE   | JARD RIVIÈRE ET TERRASSES N   | CHAUFFAGE   | EXTRA  |
| <ul style="list-style-type: none"><li>cuisine</li><li>cuisine équipée</li></ul> | <ul style="list-style-type: none"><li>Terrasse couverte</li><li>Terrasse ouverte</li><li>Feux extérieurs</li><li>irrigation automatique</li><li>arbres fruitiers</li><li>Palm</li><li>Playground</li><li>clôtures</li><li>murs en pierre</li><li>hayon</li><li>cuisine d'été</li><li>barbecue / grill</li><li>Jard RIVER n privée</li></ul> | <ul style="list-style-type: none"><li>chauffage buif Enfants cheminée</li></ul> | <ul style="list-style-type: none"><li>intégré</li><li>Alarme</li><li>Porte de sécurité</li><li>Double vitrage</li><li>porte Videocamara</li><li>Satellite TV</li><li>la surveillance vidéo</li><li>stockage</li><li>Laundry</li><li>Internet</li></ul> |



Localización de la parcela B-7. Vivienda tipo B



El complejo residencial se encuentra situado en uno de los parajes con mayor encanto de la costa levantina, Balcón de Finestrat. Rodeado de montañas y con unas vistas privilegiadas hacia la costa de Benidorm, Habitat Creativa ha creado un complejo de 16 villas de 225 m<sup>2</sup>. La superficie de la parcela de esta villa abarca 546,04 m<sup>2</sup>, y está programada con 4 dormitorios y 4 cuartos de baño.

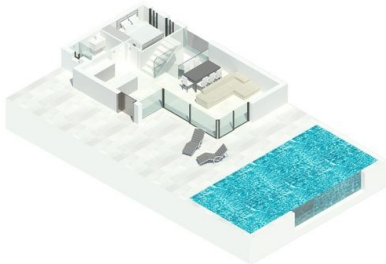

Programa Planta Baja

|            |                       |
|------------|-----------------------|
| Cocina     | 9,97 m <sup>2</sup>   |
| Salón      | 30,29 m <sup>2</sup>  |
| Dormitorio | 9,40 m <sup>2</sup>   |
| Baño       | 4,00 m <sup>2</sup>   |
| Terrazas   | 125,23 m <sup>2</sup> |

Planta Baja



Planta Sótano

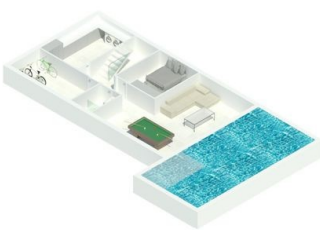
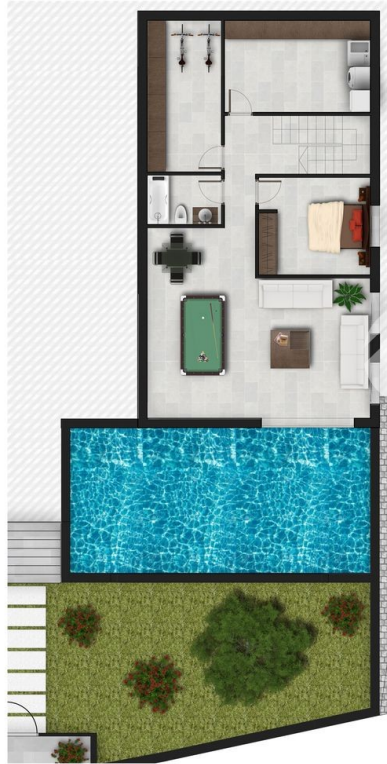

Programa Planta Sótano

|            |                      |
|------------|----------------------|
| Salón      | 34,75 m <sup>2</sup> |
| Dormitorio | 11,40 m <sup>2</sup> |
| Lavadero   | 13,98 m <sup>2</sup> |
| Trastero   | 11,75 m <sup>2</sup> |
| Baño       | 3,85 m <sup>2</sup>  |
| Escaleras  | 10,00 m <sup>2</sup> |

Planta Primera



Programa Planta Primera

|              |                      |
|--------------|----------------------|
| Dormitorio 1 | 11,27 m <sup>2</sup> |
| Baño 1       | 2,65 m <sup>2</sup>  |
| Terraza 1    | 8,15 m <sup>2</sup>  |
| Dormitorio 2 | 12,24 m <sup>2</sup> |
| Baño 2       | 4,10 m <sup>2</sup>  |
| Terraza 2    | 13,45 m <sup>2</sup> |
| Pasillo      | 2,44 m <sup>2</sup>  |



Planta Cubierta



Programa Planta Cubierta

|          |                      |
|----------|----------------------|
| Solarium | 52,33 m <sup>2</sup> |
|----------|----------------------|

