



REF: # 11170



#### INFO

|                         |             |
|-------------------------|-------------|
| <b>PRIX:</b>            | 447.000 €   |
| <b>TYPE:</b>            | Appartement |
| <b>CITY:</b>            |             |
| <b>CHAMBRES:</b>        | 2           |
| <b>Ba ENFANTS:</b>      | 2           |
| <b>Built ( m2 ):</b>    | 75          |
| <b>pas ( m2 ):</b>      | -           |
| <b>Terrasse ( m2 ):</b> | -           |
| <b>A ENFANTS:</b>       | -           |
| <b>de plante:</b>       | -           |
| <b>MESSAGE</b>          | -           |



#### DESCRIPTION

NEW BUILD RESIDENCIAL WITH SPECTACULAR SEA VIEWS IN VILLOJOYOSA LIVE BY THE SEA New Build unique residential area on the Costa Blanca due to its unbeatable panoramic views and its incredible common areas. You can take a relaxing bath throughout the year while you contemplate the Mediterranean, since its pool and jacuzzis are heated. Sports lovers will enjoy a complete gym and an enviable environment in which to practice water sports. The little ones will have a great time in their playgrounds in and out of the water. PANORAMIC VIEWS The common areas and the houses have beautiful views of the sea. Depending on the orientation and height of the house you can enjoy views of the common areas, the pool and the different beaches and coves. SPACIOUS HOUSES 3 bedrooms bungalows with large terrace and garden. Excellent qualities that include, among others, hot / cold air conditioning through ducts and underfloor heating in the bathrooms, being able to personalize your home between different finishing options. All homes include a parking space. NEXT TO THE BEACH La Cala Bolnou is in front of the residential complex, just 130 meters away. On both sides we find several more beaches, Playa Paraíso (with more than 1.060 meters long and several beach bars),

Playa el Asparalló (next to cliffs of difficult access and crystal clear waters) and Cala Higuera or “La Caleta”. WITH ALL SERVICES The residential is in Villajoyosa that has all the necessary services available all year round, in addition to its charm, gastronomy and popular festivals. The city of Alicante is 15 minutes away with the airport, high-speed train, port and the most complete health, leisure and shopping services that a large city provides. 8 minutes away is the city of Benidorm with shopping centers and all tourist leisure services.



VIEW

- Panoramico









































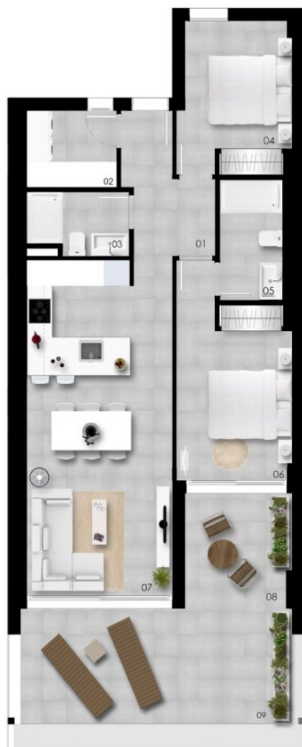

### Tipología 3



\*Superficie variable según vivienda  
Variable surface according to apartment  
Surface variable selon l'unité d'habitation

| SUPERFICIES ÚTILES   OCCUPIABLE AREA   ZONE OCCUPIABLE                     |   |                             |
|--|---|-----------------------------|
| 01   | Vestíbulo   Hall   Hall d'entrée                                      | 5.40 m <sup>2</sup>         |
| 02   | Lavadero   Laundry   Buanderie  | 3.75 m <sup>2</sup>         |
| 03   | Baño 02   Bathroom 02   Toilette 02                                   | 3.30 m <sup>2</sup>         |
| 04   | Habitación 02   Bedroom 02   Chambre 02                               | 9.11 m <sup>2</sup>         |
| 05   | Baño 01   Bathroom 01   Toilette 01                                   | 4.15 m <sup>2</sup>         |
| 06   | Habitación 01   Bedroom 01   Chambre 01                               | 11.84 m <sup>2</sup>        |
| 07   | Salón-Comedor-Cocina   Living room-Kitchen   Salle à manger-Cuisine   | 26.72 m <sup>2</sup>        |
| <b>TOTAL SUPERFICIE ÚTIL   TOTAL OCCUPIABLE AREA   ZONE UTILE TOTALE</b>   |   | <b>64.27 m<sup>2</sup></b>  |
| -  | SUP. CONSTRUIDA INTERIOR   INSIDE BUILD AREA   INTÉRIEUR SURFACE BÂTI | 80.30 m <sup>2</sup>        |
| 08   | SUP. TERRAZA CUBIERTA   COVERED TERRACE AREA   TERRASSE COUVERTE      | 7.15 m <sup>2</sup>         |
| 09   | SUP. TERRAZA DESCUBIERTA   OUTDOOR TERRACE AREA   TERRASSE EXTÉRIEURE | 22.75 m <sup>2</sup>        |
| <b>TOTAL SUPERFICIE CONSTRUIDA   TOTAL BUILD AREA   TOTAL SURFACE BÂTI</b> |   | <b>110.20 m<sup>2</sup></b> |
| -  | Solarium   Solarium   Solarium  | 0 m <sup>2</sup>            |
| -  | Jardín privado   Private garden   Jardin privé                        | 0 m <sup>2</sup>            |
| <b>TOTAL SUPERFICIE PRIVADA   TOTAL PRIVATE AREA   ESPACE PRIVÉ TOTAL</b>  |   | <b>110.20 m<sup>2</sup></b> |

**"OUR EXPERIENCE IS YOUR GUARANTEE"**